



worldskills

COMPETITION 2022
SPECIAL EDITION

Presented by

SAMSUNG

Event handbook

Nuremberg Germany

38 - Refrigeration and Air Conditioning



Contents

City information	3
City map	3
Currency	3
Power	4
Public transport	4
Shopping	4
Taxis	4
Weather	5
Event information	6
Accommodation	6
Accreditation	6
Arrivals and departures	7
Catering	8
Ceremonies	9
Competition venue	10
Daily transfers	11
Event communication	11
First aid	12
Prevention and control of COVID-19	13
Security	14
Visitors	14
Accreditation-only packages	15
Accreditation	15
Important note	15
Services	16
Venue access	16
Skill competitions	17
Programme	18
Event contacts	19
Revisions	20

Disclaimer

All information is correct at the date of issue and is subject to change.

The latest update of this handbook can be found at <https://worldskills2022se.com>.

City information

City map

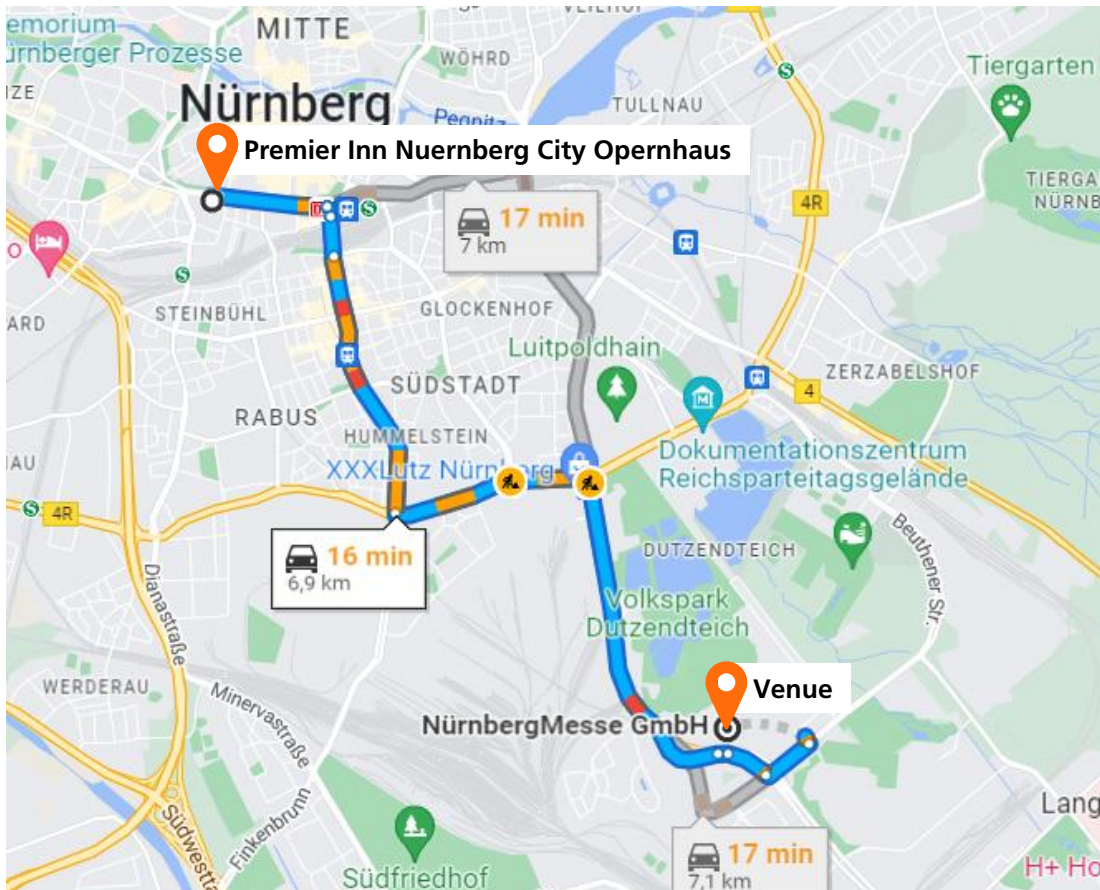

The hotel is approximately 6.9 km from the Competition venue.

Currency

Germany uses the euro

- **Symbol:** €
- **Code:** EUR

There are many ATMs (automatic teller machines) where you can withdraw cash (Euro) near the hotel and at the competition venue.

Power

230V 50Hz

These are the electricity plug-ins you can use in Germany.

Please note: It is the participants responsibility to ensure they have appropriate plug-ins and adapters where necessary, including Competitors for their skill tools.

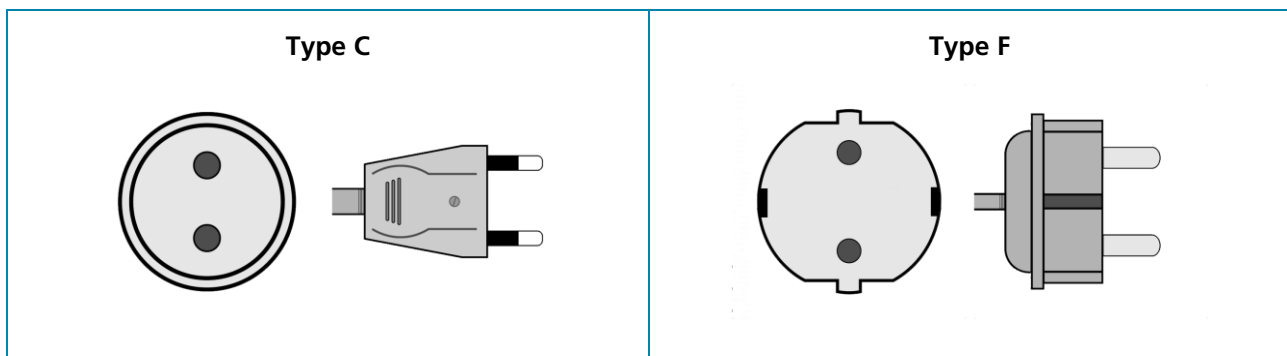

Public transport

You can reach the Competition venue by train from near the hotel.

- Train station near the Hotel Premier Inn: Subway-Station Plärrer
- Train station near the Competition venue: Messe/Fair

Shopping

Essential shops can be found in Nuremberg within close proximity to the hotel and venue as follows.

Hardware store

- Franken-Center (Glogauer Str. 30-38, 90473 Nürnberg)
- Langwasser-Center 90473 Nürnberg

Grocery store

- Franken-Center (Glogauer Str. 30-38, 90473 Nürnberg)
- Langwasser-Center 90473 Nürnberg -
- Messe Nürnberg

Pharmacy

- Zollhaus Apotheke Ebermayerstraße 20, 90471 Nürnberg
- Apotheke am Brunnenhof Euckenweg 27, 90471 Nürnberg

Taxis

There are numerous taxis available at the taxi stands at various locations in the city of Nuremberg. Taxis can also be organized over the phone or stopped on the streets by waving.

The nationwide telephone number for taxis is 22456.

Weather

The average minimum temperature (usually the minimum temperature is noted during the night) in Nuremberg in October is 5.3°C (41.54°F). The amount of rain in October is normal with an average of 53mm (2.1in). The average maximum daytime temperature lies around 14°C (57.2°F). The sun will occasionally show itself with 115 hours of sunshine during the whole month.

Event information

Accommodation

Participants with a full paid package will be accommodated at:

Premier Inn Nuremburg City Opernhaus hotel

Frauentorgraben 53, 90443 Nuernberg

Tel: +49 911 95035199

<https://www.premierinn.com/gb/en/hotels/germany/bavaria/nuremberg/nuremberg-city-opernhaus.html>

Laundry

There is laundry service at the hotel.

Accreditation

Each person who is required to be on site outside the areas open to the general public before, during, and after the Competition is required to have an accreditation badge clearly displayed.

On arrival, full package holders will collect their accreditation from the hotel welcome desk.

Zones

- | | |
|-----|--------------------------------------|
| 1 | Access to skill competition workshop |
| 2 | Access to support offices |
| DE4 | Full package (Transport, Meals) |
| DE4 | Accreditation-only |



Arrivals and departures

Upon arrival at one of the specified locations those with paid packages will be transferred to their hotel. Transfers will be scheduled according to the arrival details provided in the WSI Registration System.

When it is time to depart those with paid packages will be transferred from their hotel to the specified departure locations.

Arrivals services operate on C-4, departures services operate on C+2.

If you arrive one day prior to arrivals, or depart one day after departures, please contact the Host and to confirm if transfer arrangements are possible.

Multiple packages – for participants who have multiple packages, and your arrival and departure dates fall outside the two scenarios outlined above, you are responsible for co-ordinating your own transfers.

If you have any issues during your arrival and departure, or cannot find a member of our staff please contact the Client Support help line: +49 711 4798-9332

Locations

 Nuremberg Central Railway Station

 [Nuremberg Airport](#) (NUE)

Guests will be greeted at the main arrivals' hall of the airport and main train station by personnel with WorldSkills Competition 2022 Special Edition signs and a welcome desk and will guide you to your transfer.

Guests will receive either a shuttle service or travel card with guidance to the Subway Line.

Catering

Breakfast, lunch, and dinner are included in all paid packages.

Breakfast

Breakfast will be served at the hotel for all participants between 06:00 and 08:00 each day.

Lunch

Lunch will be served at the venue between 12:00 and 14:00. Competitors will have lunch at their hotels on C-3 and C+1.

	C-4	C-3	C-2	C-1	C1	C2	C3	C4	C+1	C+2
SCM	✂	✂	✂	✂	✂	✂	✂	✂	✂	
CE, DCE		✂	✂	✂	✂	✂	✂	✂	✂	
TD, TDA		✂	✂	✂	✂	✂	✂	✂	✂	
E, I		✂	✂	✂	✂	✂	✂	✂	✂	
C and all others		🏨	✂	✂	✂	✂	✂	✂	🏨	

🏨 Hotel, ✂ Venue

Dinner

Dinner will be served at the venue between 17:30 and 19:30. Competitors will have dinner at their hotels each night.

	C-4	C-3	C-2	C-1	C1	C2	C3	C4	C+1	C+2
SCM	🏨	✂	✂	👤	✂	✂	✂	✂	👤👤	
CE, DCE	🏨	✂	✂	👤	✂	✂	✂	✂	👤👤	
TD, TDA	🏨	✂	✂	👤	✂	✂	✂	✂	👤👤	
E, I	🏨	✂	✂	👤	✂	✂	✂	✂	👤👤	
C and all others	🏨	🏨	🏨	👤	🏨	🏨	🏨	🏨	👤👤	

🏨 Hotel, ✂ Venue, 👤 Opening Ceremony, 👤👤 Closing Ceremony

Food outlets at the venue

From C-3 to C4 there will be food outlets near the Competition venue for delegates to purchase their own meals and refreshments (particularly for the accreditation only package holders and general visitors). These are:

Supermarket:

- REWE Supermarket, Matthäus-Herrmann-Platz 2, 90471 Nürnberg
- LIDL Supermarket, Kallmünzer Str. 16, 90478 Nürnberg
- Mohamad El-Faourie Lebensmittelgeschäft, Neuselsbrunn 28, 90471 Nürnberg

Restaurants:

- Tangram , Münchener Str. 283, 90471 Nürnberg
- Gutmann am Dutzendteich, Bayernstraße 150, 90478 Nürnberg

Ceremonies

Opening Ceremony

- **Date:** 9 October 2022, 18:00
Venue: MesseNürnberg/Fair Hall 3, Onsite the Competition area
Access: Full package holders, accreditation-only holders, and invited guests

Closing Ceremony

- **Date:** 14 October 2022, 18:00
Venue: Fair CongressCenter, Room Munich I/II
Access: Full package holders, accreditation-only holders, and invited guests

Competition venue

[Messe Nürnberg](#) as part of [Chillventa](#).

Venue type: Exhibition.

Visitor access: Open to the public.

(Registration and fee to [Chillventa](#) is required.)

Accredited personnel access: WorldSkills Germany have organized with Chillventa to include the WorldSkills Accreditation Badge as an official badge that will gain the user access to the fair. The door security at the Fair will check the badge matches the person and allow access.

Map

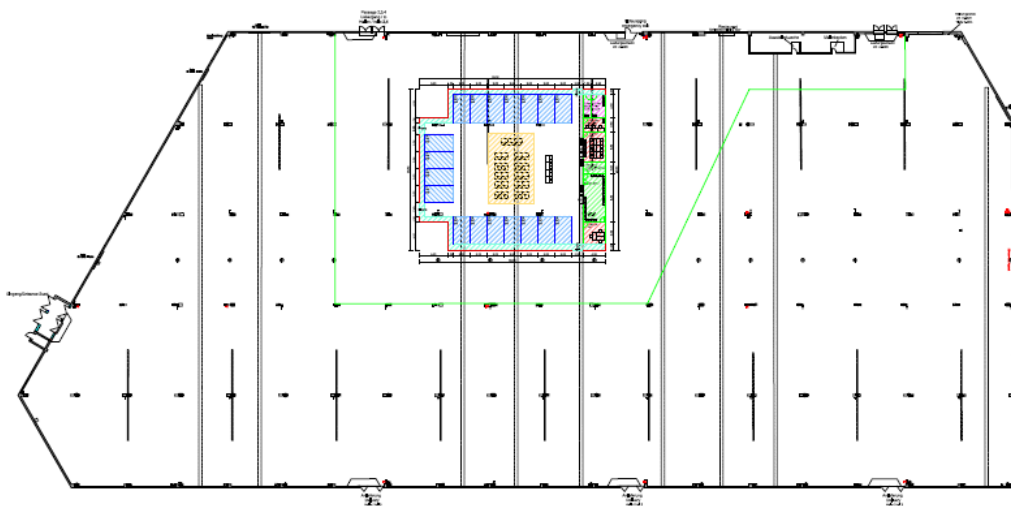

Access times

Entry to the venue will be controlled to ensure the appropriate preparation time for relevant participants.

	C-4	C-3	C-2	C-1	C1	C2	C3	C4	C+1	C+2
SCM	07:00-20:00	07:00-20:00	07:00-20:00	07:00-17:00	07:00-22:00	07:00-22:00	07:00-22:00	07:00-23:00	07:00-14:00	No access
CE, DCE	No access	07:30-20:00	07:30-20:00	07:30-17:00	07:30-22:00	07:30-22:00	07:30-22:00	07:30-23:00	07:30-14:00	No access
TD, TDA	No access	07:30-20:00	07:30-20:00	07:30-17:00	07:30-22:00	07:30-22:00	07:30-22:00	07:30-23:00	07:30-14:00	No access
E, I	No access	08:00-20:00	08:00-20:00	08:00-17:00	08:00-22:00	08:00-22:00	08:00-22:00	08:00-23:00	08:00-14:00	No access
C and other accredited	No access	No access	08:30-20:00	08:30-16:00	08:30-18:00	08:30-18:00	08:30-18:00	08:30-14:00	No access	No access
Visitors	No access	No access	No access	No access	09:00-17:00	09:00-17:00	09:00-17:00	09:00-17:00	No access	No access

Daily transfers

Full package holders have access to daily transportation as part of their package.

The daily transportation will be by shuttle or public transport to and from the venue. Daily schedules will be provided to delegates in Nuremberg.

Event communication

Event Wi-Fi

Competitors and Experts will receive access to the Wi-Fi at the Competition venue.

Local SIM cards

SIM cards can be purchased in every Grocery Store in Nuremberg (details in Shopping section above).

WhatsApp group

Participants are encouraged to join this group to receive information during the event. Participants will not be able to post but will be kept up to date if there any announcements that they need to know.

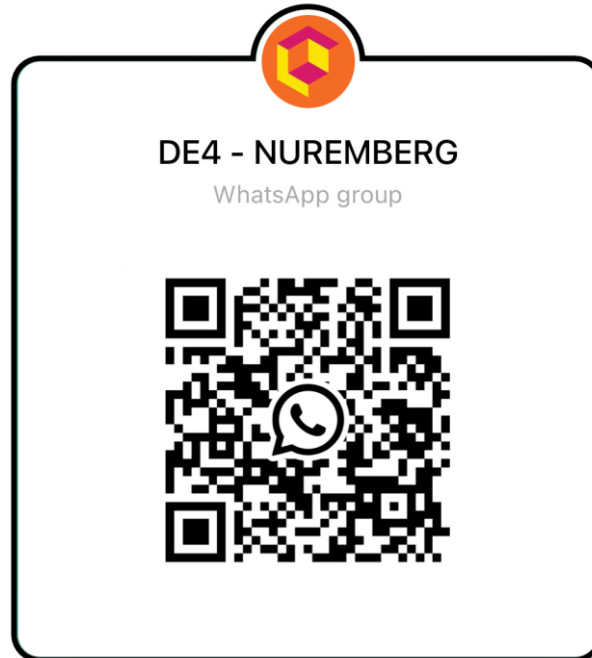

Open this link or scan the QR code to join the WhatsApp Group:

DE4 - <https://chat.whatsapp.com/FfkxBfZQP48HFLkadigGW>

First aid

Onsite: At the Competition venue a first aid station will be available within the workshop and information will be given at the briefing onsite at C-2. For all injuries report them to the Expert, SCM or Host who will assess the requirements. If an ambulance is required one will be called on 112.

Outside venue: A pharmacy details can be found in the Shopping section above and can be used for minor injuries. Please advise Client Support of any injuries. For more severe injuries please call 112 for an ambulance and let Client Support know where they can assist.

Prevention and control of COVID-19

International travel procedures

- **General COVID-19 travel restrictions:** Currently there are no COVID-19 travel restrictions to enter Germany.
- **Vaccinated, recovered or tested:** For entry into Germany, it is no longer necessary to present proof of vaccination, proof of convalescence or proof of testing.
- **Pre-Travel-Clearance:** Currently, no Pre-Travel-Clearance is required when entering Germany.
- **Exception:** Countries where virus mutations are widespread are classified by the federal government as "virus variant areas." Special requirements apply to entrants who have stayed in such an area within 10 days prior to their entry into Germany. However, currently all countries have been cleared from the virus variant areas list. For latest information please check at:
https://www.rki.de/DE/Content/InfAZ/N/Neuartiges_Coronavirus/Risikogebiete_neu.html

IMPORTANT: In addition to the German entry regulations, please also pay attention to the current rules of your country of origin by checking the official government websites. Especially ensure that you have full understanding of the requirements for re-entry back into your own country as well as countries you might be transiting through when traveling as part of WSC2022SE.

Local COVID-19 procedures

- **COVID-19 rules during your stay in Germany:** Most COVID-19 restrictions have been lifted in Germany. However, basic protection such as mandatory face masking in hospitals or care facilities remain. Compulsory face masking in public transport can also be mandatory depending on each federal state / region. The mask requirement remains in place nationwide for long-distance passenger transport including air travel and rail travel.

PLEASE NOTE: Currently, the exact regulations are set individually by the respective federal state / region. The measures can therefore differ from one federal state to the next. Refer to bellow tab for individual states' official websites.

State	City & Skill	Official website to follow
Bayern / Bavaria	<ul style="list-style-type: none"> • Nürnberg (Skill: 38) 	https://www.innenministerium.bayern.de/corona/index.php

- **Public meetings and events are allowed.**
- **If you have tested positive for COVID-19 during your stay in Germany:** If you have tested positive for COVID-19 or suspect that you may be ill, it is recommended to stay home and avoid contact with other people.
 - Isolation ends with a negative nucleic acid test (e.g. PCR test) or at the earliest after five days following the positive test, if the affected person has been symptom-free for at least 48 hours, or at the latest after ten days.
 - It is recommended to wear an FFP2 mask outside your home / accommodation - especially indoors - for a further five days after the end of isolation and to avoid unnecessary contact with other people. Please check individual states on specific rules for isolation.
- **Official COVID-19 information website for Germany:** <https://www.bundesregierung.de/breg-de/themen/coronavirus/corona-regeln-und-einschrankungen-1734724>

Competition COVID-19 procedure

- **COVID-19 rules at Competition venue:** No additional COVID-19 rules other than current government guidelines are planned during the competition in Germany.

Security

No specific security measures. Regular entrance and security check of the fair. Explosive items are not allowed. WSC2022SE accredited participants can bring to the venue specific tools and toolboxes required for their Skill.

Visitors

Any visitor for the WorldSkills event will need to submit their contact details via <https://www.worldskillsgermany.com/worldskills2022se/nuremberg-eng/>

The visitor will then get a direct link to the Fair to register for the Fair via the special link to receive entry at no cost. Visitors can only access the Competition venue on C1 till C4 during the open hours of the Fair.

Accreditation-only packages

For this special edition Competition, it was agreed that accreditation-only packages would be offered to participants who did not require a full duration paid package. This means that accreditation-only package holders do not have access to many of the services within the paid packages.

Accreditation

Each person who is required to be on site outside the areas open to the general public before, during, and after the Competition is required to have an accreditation badge clearly displayed.

Accreditation-only package holders will collect their accreditation from the registration desk at the Competition venue.

Important note

Members and Partners must understand that the Host incurs costs and administrative duties related to accreditation-only packages, therefore Members and Partners need to be considerate by providing accurate data.

All Members and Partners who have accreditation-only packages in the system need to assess their requirements and advise client.support@worldskills.org if there are any participants now not attending so these can be removed from the WSI system.

Please note that new accreditation-only packages cannot be added at this time.

Services

Package element	Accreditation-only package	Comments
Accommodation	✗	To be organized by delegate
Arrivals and departure transfer	✗	To be organized by delegate
Food and beverage	✗	To be organized by delegate
Daily transfers	✗	To be organized by delegate
Excursion (or cultural experience)	✗	N/A
Opening ceremony	✓	For DE4, the Host has included this at no additional charge.
Closing ceremony	✓	For DE4, the Host has included this at no additional charge
Welcome dinner	✗	N/A
Farewell dinner	✗	N/A
Accreditation	✓	For DE4, the Host has included this at no additional charge

Venue access

WorldSkills Germany have organized with Chillventa to include the WorldSkills Accreditation Badge as an official badge that will gain the user access to the fair. The door security at the Fair will check the badge matches the person and allow access.

Skill competitions

Skill	Competing Members	SCM, CE, DCE	CCD, Skill Advisor
38 Refrigeration	AT AU CA DE ES FR HK IN IR JP KR NA PH PT TW ZA	Noel Munkman Hyun-Ju Mun KR Karsten Beermann DE	Jens Bielicke DE Sens Shoolongo NA Jorge Mauricio

Programme

Summary

C-4	Thursday, 6 October	Arrivals
C-3	Friday, 7 October	Preparation
C-2	Saturday, 8 October	Preparation Familiarization
C-2	Sunday, 9 October	Familiarization Opening Ceremony
C1	Monday, 10 October	Day 1
C2	Tuesday, 11 October	Day 2
C3	Wednesday, 12 October	Day 3
C4	Thursday, 13 October	Day 4
C+1	Friday, 14 October	Closing Ceremony
C+2	Saturday, 15 October	Departures

Event contacts

WSC2022SE – DE4 event support details are:

hospitality@worldSkillsgermany.com

+49 711 4798-9332

Revisions

Version	Date	Changes
1.0	29.09.22	<ul style="list-style-type: none">Initial release.
